

# E14- E18 D0 NEOZED SİĞORTALAR E14 -E18 D0 NEOZED FUSE SYSTEMS

1.2

**YENİ  
NEW**

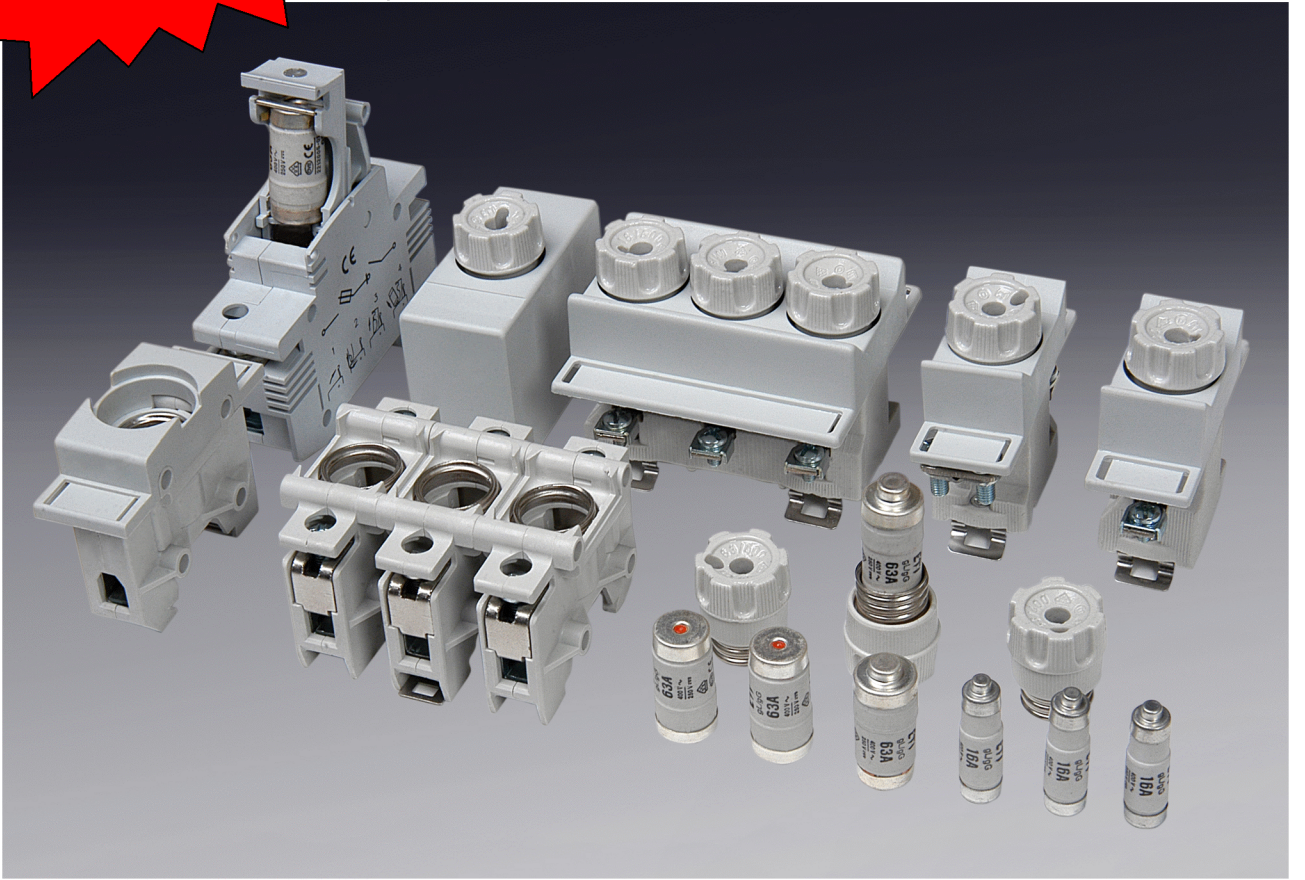

**KALEPORSELEN**  
elektroteknik sanayi a.ş.

“1969'dan beri aydınlığa giden yol” “Way to brightness since 1969”

## E14 -E 18 D0 SİGORTA SİSTEMİ

D0 sigorta buşonları kısa devre akımı ve aşırı yüklerle karşı devreyi korumak için kullanılır.

D0 sigorta sistemi, gövde kapak, buşon ve diğer aksamdan oluşur. Sigorta buşonları 2A den100A'e kadar üretilir. Buşon gövdeleri, standard seramikten, gövdeler ise seramik veya plastik malzemeden üretilir.

Sigorta sistemi 400V AC veya 250V DC karşılayacak şekilde dizayn edilmiştir.

D0 sigorta sistemi iş yerlerinde ve benzer binalarda kullanılır. Endüstriyel alanlarda, hava sirkülasyonu, gerilim atlama mesafesi ve montaj mesafeleri dikkate alınarak IEC 60664-1 şartları karşılayacak şekilde gerekli önlemler alınarak kullanılabilir.

### D0 sigorta sisteminin avantajları.

- Düşük güç kaybı
- Düşük sıcaklık
- Taşıma, depolama ve montaj kolaylığı
- Parça ve final ürünlerde kalite devamlılığı

### Teknik Veriler

Anma gerilimi	400V
Anma akımı	D01 2A-16A, D02 20A-63A D03 80A-100A

Kesme kapasitesi 1,1Un	50kA CosØ 8 kA == T=15ms
Buşon karakteristiği	gG(gL)

Standartlar	TS EN 60269, IEC 60269 DIN VDE 0636
-------------	--

## E14-E18 D0 NEOZED FUSE SYSTEMS

D0 Fuse links are used as the reliable protection of elektro installation, control and signal circuits against overload and short circuit currents.

The whole system D0 contains a complete range of fuse – links ,standard ceramic and new plastic bases ,fuse dis connectors and all necessary accessories . It is dimensioned for rated voltages 400V a.c rep.250 V d.c.

The system D0 is intended to be used in residential, business and similar buildings . When it is used in industrial plants, it is necessary to take into account the requirements of the standard IEC 60664-1 concerning the air insulation distances, creeping distances and mounting distances

### Advantages

- Low power loss
- Smaller warning
- Saving of store and mounting place
- Constant quality control of parts and final products

### Technical Data

Rated voltage Un	400V ~
Rated current In	D01 2A-16A, D02 20A-63A D03 80A-100A
Breaking capacity 1,1Un	50kA CosØ 8 kA == T=15ms
Fusing characteristics	gG(gL)

Standards	TS EN 60269, IEC 60269 DIN VDE 0636
-----------	--



In(A)	Renk Colour	Mamul Kodu (Product No)	gr/Ad gr/pcs	Adet pcs
2	Pembe/Pink	12.1002.10	6	10
4	Kahve/Brown	12.1004.10	6	10
6	Yeşil/Green	12.1006.10	6	10
10	Kırmızı/Red	12.1010.10	6	10
13	Siyah/Black	12.1013.10	6	10
16	Gri/Grey	12.1016.10	6	10

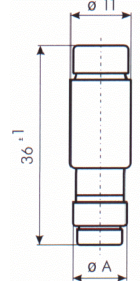

In(A)	Renk Colour	Mamul Kodu (Product No)	gr/Ad gr/pcs	Adet pcs
20	Mavi/Blue	12.2020.20	11	10
25	Sarı/Yellow	12.2025.20	12	10
32	Siyah/Black	12.2032.20	13	10
35	Beyaz/White	12.2035.20	13	10
40	Siyah/Black	12.2040.20	13	10
50	Beyaz/White	12.2050.20	13	10
63	Bakır/Copper	12.2063.20	15	10

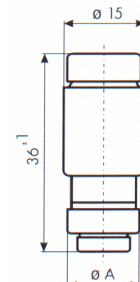

In(A)	Renk Colour	Mamul Kodu (Product No)	gr/Ad gr/pcs	Adet pcs
80	Gümüş/Silver	12.3080.30	35	10
100	Kırmızı/Red	12.3100.30	35	10

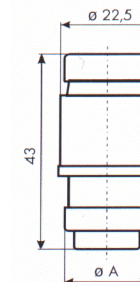



## SİGORTA GÖVDELERİ

### Uygulama

D0 sigorta gövdeleri binalarda dağıtım kutularında kullanılacak şekilde dizayn edilmiştir. Standard raylı dağıtım kutularına D0 sigorta gövdeleri yerleştirilerek gerilim altındaki tüm parçalar güvenlik altına alınır .

### Avantajları

- Modüler yerleştirmeye uygundur. 9mm
- Hafif ve küçük olduğundan dolayı derinliği 80 mm olan dağıtım kutularına kolaylıkla monte edilebilir.
- İlave viskontak anahtarı yardımı ile viskontaklar gerilim altında kolaylıkla değiştirilebilir.
- D02 ile D01 gövdelerinin birbirinin yerine montajı mümkündür.

### Teknik veriler

Anma gerilimi Un	400V
Anma akımı In	DO1 16A,DO2 63A
Kablo bağlantı kesiti	DO1 1-4mm <sup>2</sup> DO2 1,5-25mm <sup>2</sup>
Montaj	Vidalı /Ray klipsli
Standardlar	TS EN 60269,IEC 60269 DIN VDE 0636

## FUSE BASES

### Application

The fuses bases D0 are planned to be built into distribution in domestic and public buildings. Total security against parts under voltage is achieved by installing D0 fuse bases into the distribution boxes.

### Advantages

- Modular construction-module 9mm
- Smaller weight and smaller height (66mm) provide installation into the flush –mounting distribution boxes, the depth of which is 80 mm only.
- By the aid of gauge-piece key it is possible to change the gauge rings under voltage
- The possibility of simple substitution of base D01 with D02

### Technical data

Rated voltage Un	400V
Rated current In	DO1 16A,DO2 63A
Cross-section of con. lead	DO1 1-4mm <sup>2</sup> DO2 1,5-25mm <sup>2</sup>
Connection clamp	With screw /Click-on
Standards	TS EN 60269,IEC 60269 DIN VDE 0636

In(A)	Açıklama Description	Terminal tipi Type of terminal	Montaj Şekli Montage type	Örtü şekli Protection cover	Mamul Kodu (Product No)	gr/Ad gr/pcs	Adet pcs
16	E14 D01	M5 Vida/screw	Raylı/Click-on	Örtülü/ with cover	16.1014.10	68	15
16	E14 D01	M5 Vida/screw	Raylı/Click-on	Örtüsüz/without cover	16.1014.20	56	15
16	E14 D01	M5 Vida/screw	Vidalı/Screw	Örtülü/ with cover	16.1014.30	66	15
16	E14 D01	M5 Vida/screw	Vidalı/Screw	Örtüsüz/without cover	16.1014.40	59	15
63	E18 D02	M5-K Vida/screw	Raylı/Click-on	Örtülü/ with cover	16.2018.10	82	15
63	E18 D02	M5-K Vida/screw	Raylı/Click-on	Örtüsüz/without cover	16.2018.20	80	15
63	E18 D02	M5-K Vida/screw	Vidalı/Screw	Örtülü/ with cover	16.2018.30	87	15
63	E18 D02	M5-K Vida/screw	Vidalı/Screw	Örtüsüz/without cover	16.2018.40	80	15
63	E18 D02	2xM5 Vida/screw	Raylı/Click-on	Örtülü/ with cover	16.2018.50	80	15
63	E18 D02	2xM5 Vida/screw	Raylı/Click-on	Örtüsüz/without cover	16.2018.60	77	15
63	E18 D02	2xM5 Vida/screw	Vidalı/Screw	Örtülü/ with cover	16.2018.70	75	15
63	E18 D02	2xM5 Vida/screw	Vidalı/Screw	Örtüsüz/without cover	16.2018.80	72	15

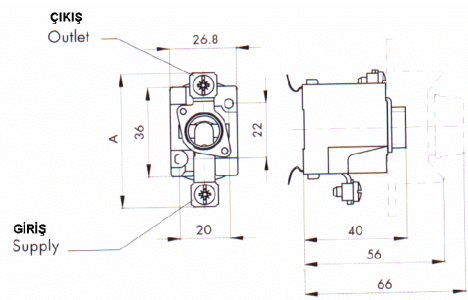
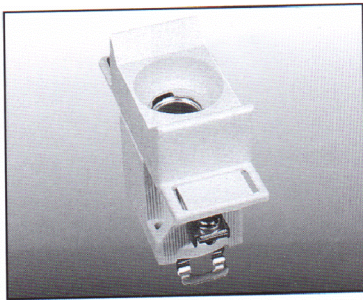

In(A)	Açıklama Description	Terminal tipi Type of terminal	Montaj Şekli Montage type	Örtü şekli Protection cover	Mamul Kodu (Product No)	gr/Ad gr/pcs	Adet pcs
16	E14 D01	M5 Vida/screw	Vidalı/Screw	U-Örtülü/U-with cover	16.1114.10	80	15
63	E18 D02	2xM5 Vida/screw	Vidalı/Screw	U-Örtülü/U-with cover	16.2118.10	90	15

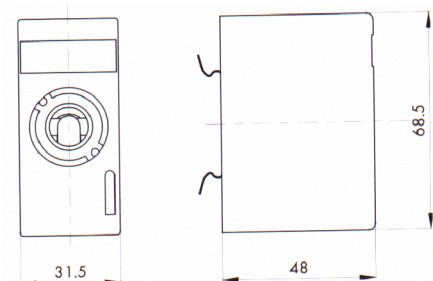
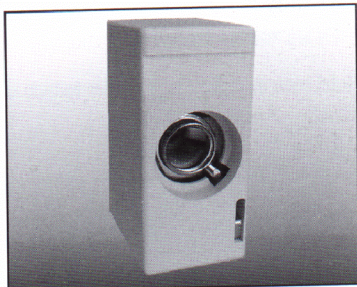

In(A)	Açıklama Description	Terminal tipi Type of terminal	Montaj Şekli Montage type	Örtü şekli Protection cover	Mamul Kodu (Product No)	gr/Ad gr/pcs	Adet pcs
16	E14 D01-3P	M4 Vida/screw	Raylı/Click-on	Örtülü/ with cover	16.1314.10	216	5
16	E14 D01-3P	M4 Vida/screw	Raylı/Click-on	Örtüsüz/without cover	16.1314.20	176	5
16	E14 D01-3P	M4 Vida/screw	Vidalı/Screw	Örtülü/ with cover	16.1314.30	187	5
16	E14 D01-3P	M4 Vida/screw	Vidalı/Screw	Örtüsüz/without cover	16.1314.40	170	5
63	E18 D02-3P	M5-K Vida/screw	Raylı/Click-on	Örtülü/ with cover	16.2318.10	220	5
63	E18 D02-3P	M5-K Vida/screw	Raylı/Click-on	Örtüsüz/without cover	16.2318.20	237	5
63	E18 D02-3P	M5-K Vida/screw	Vidalı/Screw	Örtülü/ with cover	16.2318.30	231	5
63	E18 D02-3P	M5-K Vida/screw	Vidalı/Screw	Örtüsüz/without cover	16.2318.40	214	5
63	E18 D02-3P	2xM5 Vida/screw	Raylı/Click-on	Örtülü/ with cover	16.2318.50	235	5
63	E18 D02-3P	2xM5 Vida/screw	Raylı/Click-on	Örtüsüz/without cover	16.2318.60	229	5
63	E18 D02-3P	2xM5 Vida/screw	Vidalı/Screw	Örtülü/ with cover	16.2318.70	220	5
63	E18 D02-3P	2xM5 Vida/screw	Vidalı/Screw	Örtüsüz/without cover	16.2318.80	214	5

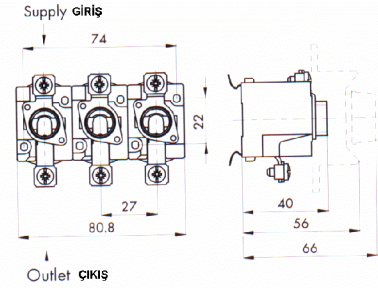
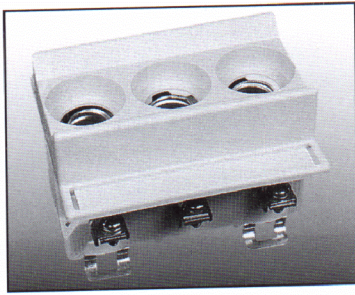

In(A)	Açıklama Description	Terminal tipi Type of terminal	Montaj Şekli Montage type	Örtü şekli Protection cover	Mamul Kodu (Product No)	gr/Ad gr/pcs	Adet pcs
16	E14 D01 1P	M5 Vida/screw	Raylı/Click-on	Örtülü/ with cover	16.1514.10	70	15
16	E14 D01 3P	M5 Vida/screw	Raylı/Click-on	Örtülü/ with cover	16.1614.10	220	3
63	E18 D02 1P	2xM5 Vida/screw	Raylı/Click-on	Örtülü/ with cover	16.2518.10	86	15
63	E18 D02 3P	2xM5 Vida/screw	Raylı/Click-on	Örtülü/ with cover	16.2618.10	270	3

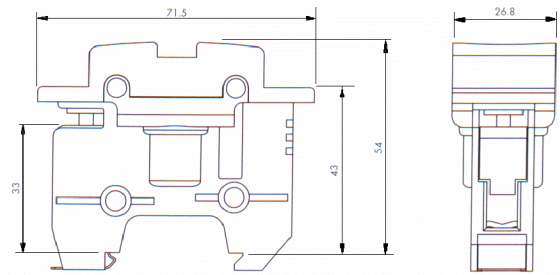
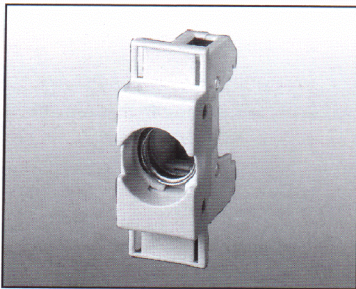

## KORUMA ÖRTÜLERİ/PROTECTION COVER

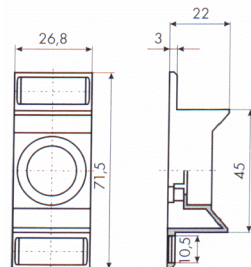
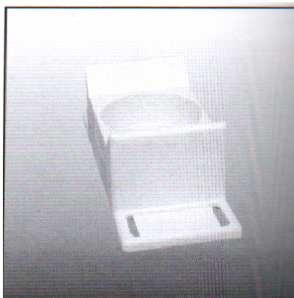

In(A)	Açıklama Description	Mamul Kodu (Product No)	gr/Ad gr/pcs	Adet pcs
16	E14 D01	16.1014.90	8	50
63	E18 D02	16.2018.90	8	50



## KORUMA ÖRTÜLERİ/PROTECTION COVER 3P

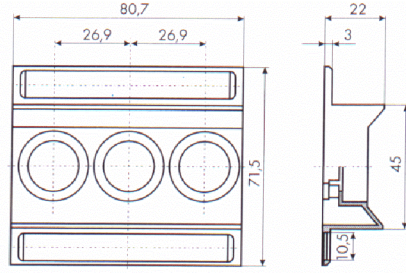
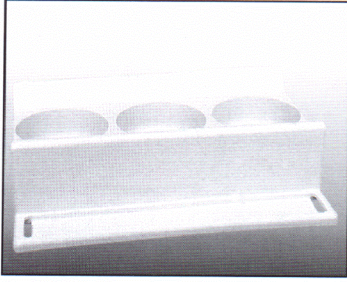

In(A)	Açıklama Description	Mamul Kodu (Product No)	gr/Ad gr/pcs	Adet pcs
16	E14 D01 3P	16.1314.90	17	14
63	E18 D02 3P	16.2318.90	160	14

## KAPAKLAR/FUSE CARRIERS

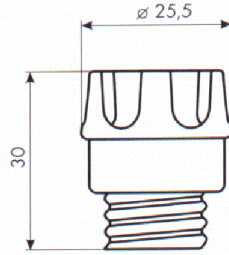
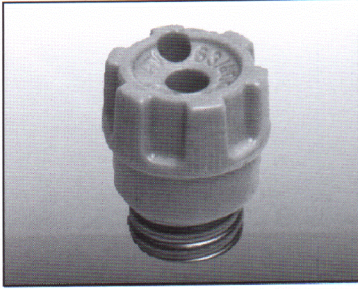

In(A)	Açıklama Description	Mamul Kodu (Product No)	gr/Ad gr/pcs	Adet pcs
16	E14 D01	14.1014.10	14	20
63	E18 D02	14.2018.10	17	20

## VİSKONTAKLAR/GAUGE PIECES

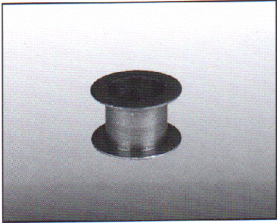

In(A)	Renk Colour	Mamul Kodu (Product No)	gr/Ad gr/pcs	Adet pcs	ØA	ØB
2	Pembe/Pink	15.1002.10	1	50	7,9	12
4	Kahve/Brown	15.1004.10	1	50	7,9	12
6	Yeşil/Green	15.1006.10	1	50	7,9	12
10	Kırmızı/Red	15.1010.10	1	50	9,1	12

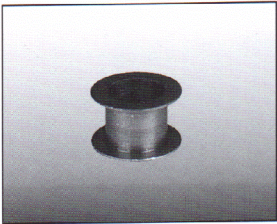
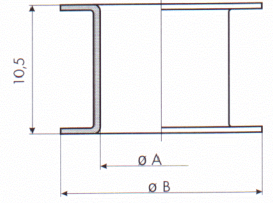

In(A)	Renk Colour	Mamul Kodu (Product No)	gr/Ad gr/pcs	Adet pcs	ØA	ØB
20	Mavi/Blue	15.1020.10	1	50	11,5	16,6
25	Sarı/Yellow	15.1025.10	1	50	12,7	16,6
35	Siyah/Black	15.1035.10	1	50	13,9	16,6
50	Beyaz/White	15.1050.10	1	50	15,1	16,6

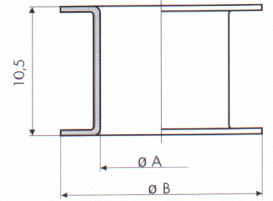

## VİSKONTAK ANAHTARI/ GAUGE PIECE KEY

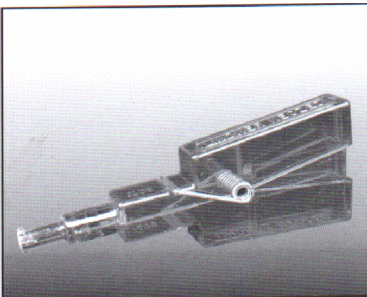

In(A)	Açıklama Description	Mamul Kodu (Product No)	gr/Ad gr/pcs	Adet pcs
		19.1070.00	17	20



**KALEPORSELEN elektroteknik sanayi a.ş.**

Halkalı Caddesi No: 160 34620

Sefaköy-K.Çekmece İstanbul/TÜRKİYE

Tel.(0212) 698 95 80 (pbx) Fax : (0212) 698 95 97

[www.kaleporselele.com.tr](http://www.kaleporselele.com.tr) [kaleporselele@kaleporselele.com.tr](mailto:kaleporselele@kaleporselele.com.tr)

**TÜRKİYE GENEL SATICIMIZ**

**KALE Power Controls**

**ELEKTRİK SİSTEMLERİ A.Ş.**

Eski Üsküdar Yolu

Bodur İş Merkezi No:8 Kat: 6

34752 İçerenköy/İSTANBUL

Tel.: (0216) 574 34 00 (Pbx)

Fax.: (0216) 574 34 05-06

**İSTANBUL BÖLGE TEMSİLCİLİĞİ**

Okçu Musa Cad. Erseven Han No:70

Kat : 1 D:2 Karaköy / İSTANBUL

Tel. : (0212) 297 86 83

Fax.: (0212) 297 86 84

**SAMSUN BÖLGE TEMSİLCİSİ**

Derecik Mah.Ankara Cad. No: 13

Yeşilkent / SAMSUN

Tel. : (0362) 438 84 34-35

Fax.: (0362) 438 84 35

**ANKARA BÖLGE TEMSİLCİLİĞİ**

Konya Devlet karayolu Kale Seramik Binası

No:82/1 06520 Balgat / ANKARA

Tel. : (0312) 286 51 86-87

Fax :. (0312) 286 51 85

**ADANA BÖLGE TEMSİLCİLİĞİ**

Turan Cemal Beriker Bulvarı

Gizerler İş Merkezi No:46 K:3 D:7

Seyhan / ADANA

Tel. : (0322) 459 74 65

Fax.: (0322) 459 74 67

**İZMİR BÖLGE TEMSİLCİLİĞİ**

Gaziler Cad. No:478/204 Yenışehir

İş Merkezi 35220 Yenışehir / İZMİR

Tel. : (0232) 457 50 51

Fax.: (0232) 433 49 04

**BURSA BÖLGE TEMSİLCİLİĞİ**

Yeni Yalova Yolu 15 km

Ovaakça Çıkışı 16370 / BURSA

Tel : (0224) 267 21 80

Fax : (0224) 267 21 81

Yetkili Satıcı :  
Authorized Dealer: